

REVISIONS				
SYM	DESCRIPTION	PREP'D BY	DATE	APPROVED
(A)	ADDED SLEEPING UNITS	H.M.S.	AUG 8/75	W.H.F.
(*)	RELOCATE LINE - AS-BUILT	J.N.P.	10 FEB 78	

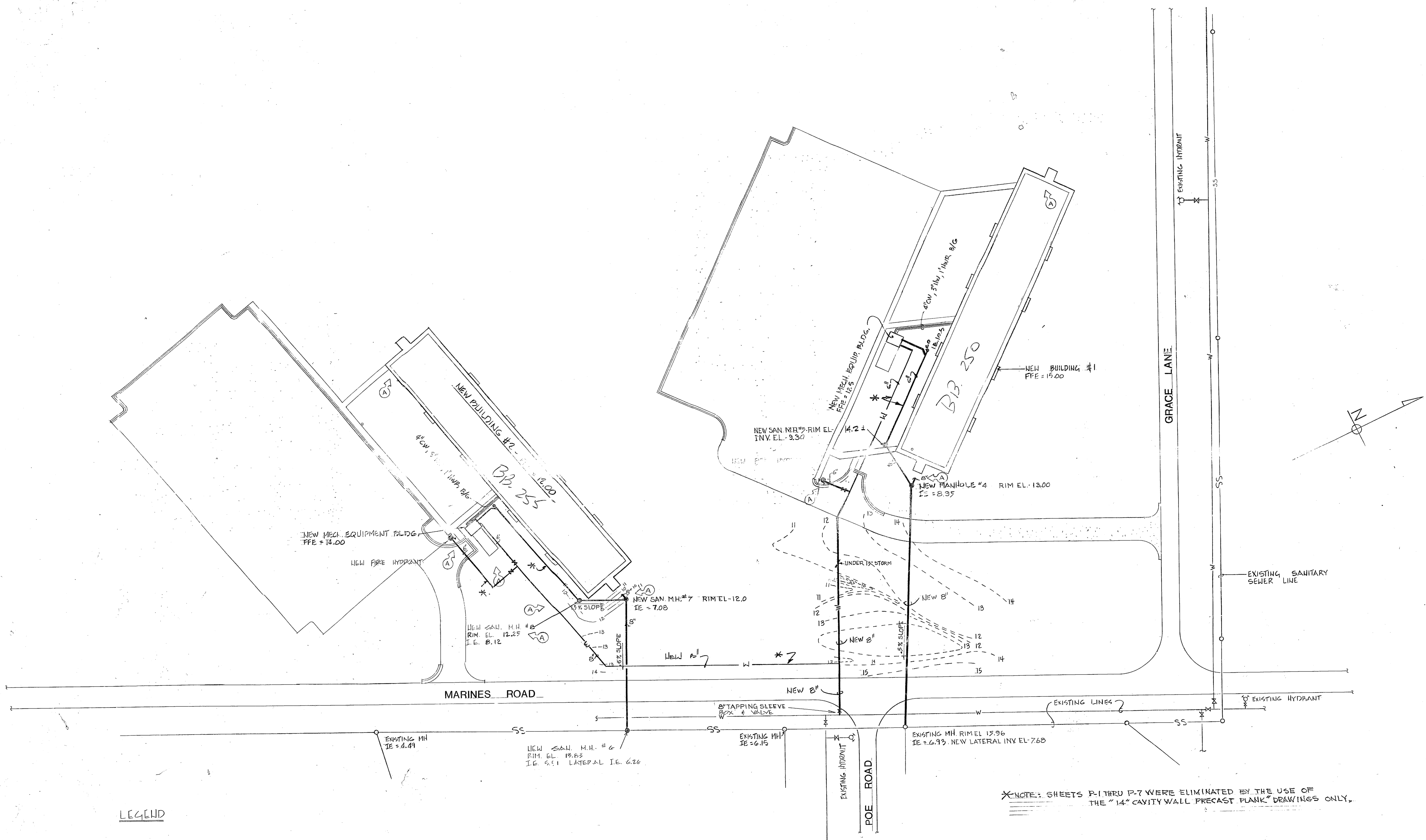

LEGEND

- — — NEW SANITARY SEWER PIPING
- — — EXIST. SANITARY SEWER PIPING
- — — NEW WATER PIPING
- — — EXIST. WATER PIPING

WATER & SANITARY PLAN - SITE C
 scale : 1" = 40'

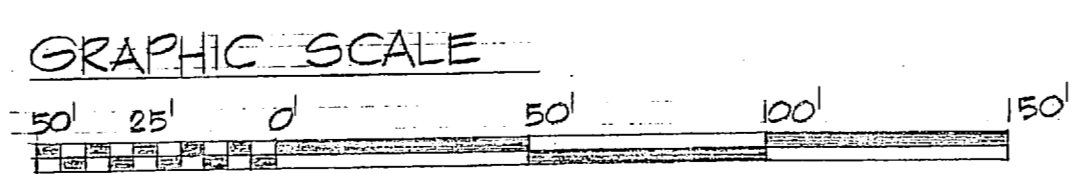

*NOTE: SHEETS P-1 THRU P-7 WERE ELIMINATED BY THE USE OF THE "14" CAVITY WALL PRECAST PLANK" DRAWINGS ONLY.

RECORD DRAWING
 DATE 10 FEB 78

	J. N. PEASE ASSOCIATES ARCHITECTS - ENGINEERS - PLANNERS CHARLOTTE NORTH CAROLINA	DEPARTMENT OF THE NAVY ATLANTIC DIVISION NAVAL STATION MARINE CORPS BASE CAMP LEJEUNE NORTH CAROLINA
	DES. HWS (DR. HWS) CHK. PROJ. MGR. D.M.M. (CH. ENGR.) SUBMITTED BY: <i>[Signature]</i> DATE: 25 APRIL 75 FIRM MEMBER: <i>[Signature]</i> PRINCIPAL	BACHELOR ENLISTED QUARTERS WATER AND SANITARY PLAN SITE "C"
P-8	APPROVED: <i>[Signature]</i> DATE: 8 MAY 1975 OFFICER IN CHARGE	LFD DWG. NO. 121501

