

ENLARGEMENT SHOWING TIE-INS FOR RAW AND TREATED WATER MAINS
SCALE 1"=10'

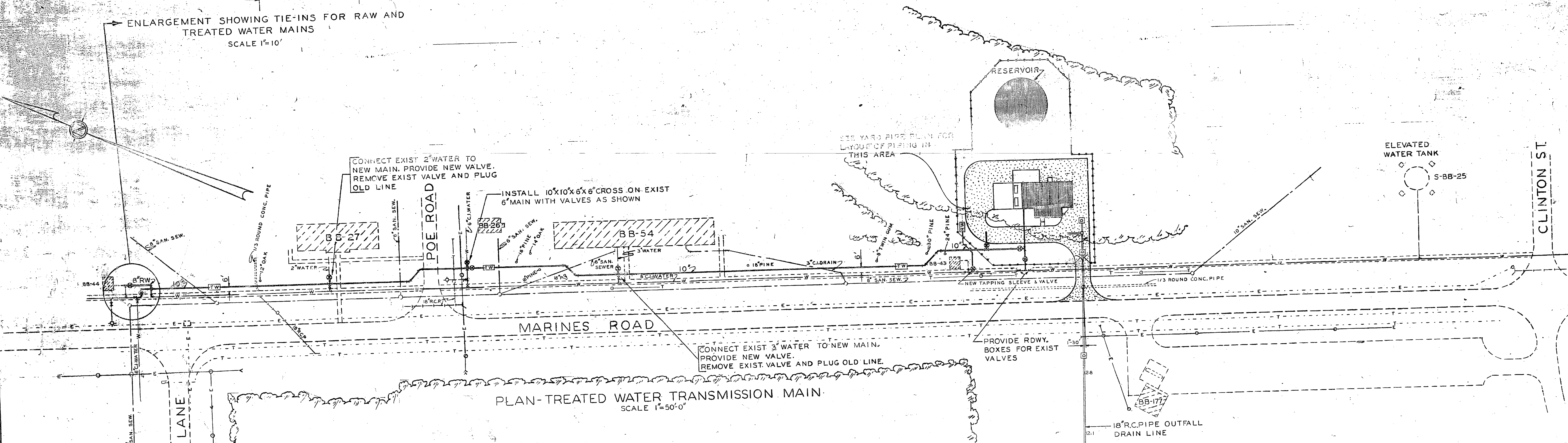

PLAN-TREATED WATER TRANSMISSION MAIN
SCALE 1"=50'-0"

- LEGEND**
- EXIST ROADS - WALKS
 - BUILDINGS
 - WOODS LINE - APPROX
 - INDIVIDUAL TREES
 - SPOT ELEVATIONS
 - WATER MAINS
 - SAN SEWER
 - OVHD POWER LINE
 - UG ELECT CABLE
 - UG TELEPHONE CABLE
 - NEW STRUCTURES
 - ASPHALT PAVEMENT
 - TREATED WATER TRANS MAIN
 - RAW WATER MAIN
 - DRAINAGE PIPE
 - CHAIN LINK FENCE

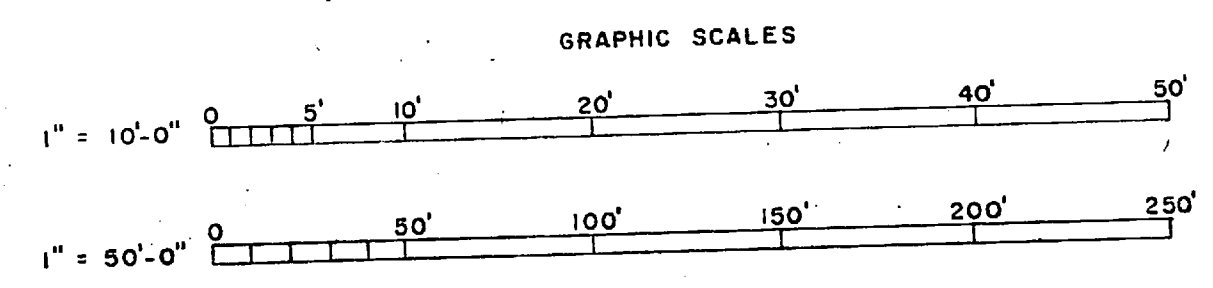

SATISFACTORY TO: *[Signature]*
THE COMMANDING GENERAL
MARINE CORPS BASE, CAMP LEJEUNE, N.C.

DATE: _____

REVISION	DATE	APPD.	DESCRIPTION	BY
PW DRAWING NO.			MARINE CORPS BASE CAMP LEJEUNE, N. C.	
DESIGNED BY: <i>[Signature]</i>			ATLANTIC DIV. NAV. FAC. ENG. COMMAND, NORFOLK, VA.	
DRAWN BY: <i>[Signature]</i>			WATER TREATMENT PLANT COURTHOUSE BAY	
TR. BY: <i>[Signature]</i>			WATER DISTRIBUTION PLANS & DETAILS	
CHK. BY: <i>[Signature]</i>			NAVY-ENGINEERING COMPANY	
SUPV. BY: <i>[Signature]</i>			SHEET 19 OF 21 NBY 86313	
IN CHARGE: <i>[Signature]</i>			NAVY-ENGINEERING COMPANY DRAWING NO. 1108389	
LANTDOCKS			SCALE GRAPHIC SPEC 88313/67	
RVD BY: <i>[Signature]</i>			APPROVED: <i>[Signature]</i> DATE: <i>10/10/67</i>	
BR MGR: <i>[Signature]</i>			PUBLIC WORKS OFFICER	
DIR DES: <i>[Signature]</i>			SHEET 19 OF 21 NBY 86313	
SATISFACTORY TO: <i>[Signature]</i>			APPROVED: <i>[Signature]</i> DATE: <i>10/10/67</i>	
THE QUARTERMASTER GENERAL OF THE MARINE CORPS			NAVY-ENGINEERING COMPANY DRAWING NO. 1108389	

N62470-68-B-0020

