

Power Line
Signal School Area
Onslow Beach

QUAD. No. 221

L

VALUABLE

SUBJECT

*Power Line
Signal School Area*

RETURN TO
PUBLIC WORKS
OFFICE

CAMP LEJEUNE
NEW RIVER, N. C.

FIELD PARTY

Pilley IN CHARGE
INSTRUMENT
NOTES
TAPE READ
TAPE OR ROD
TAPE OR ROD
INSTRUMENT No.

WEATHER

CLEAR
CLOUDY
WINDY
RAIN
FAIR

SNOW
HOT
MODERATE
COLD
FOG

FILE No.

FLDR. No.

SHEET *# 2 of*

FIGURED BY

NOTES CHECKED BY

PLOTTED BY DATE 19

TAPE No.

Quad. No.

STATION	DIST.	ANGLE ° ' "	+	H. I.	VER. ANG. DIFF.	ELEVATION
---------	-------	----------------	---	-------	--------------------	-----------

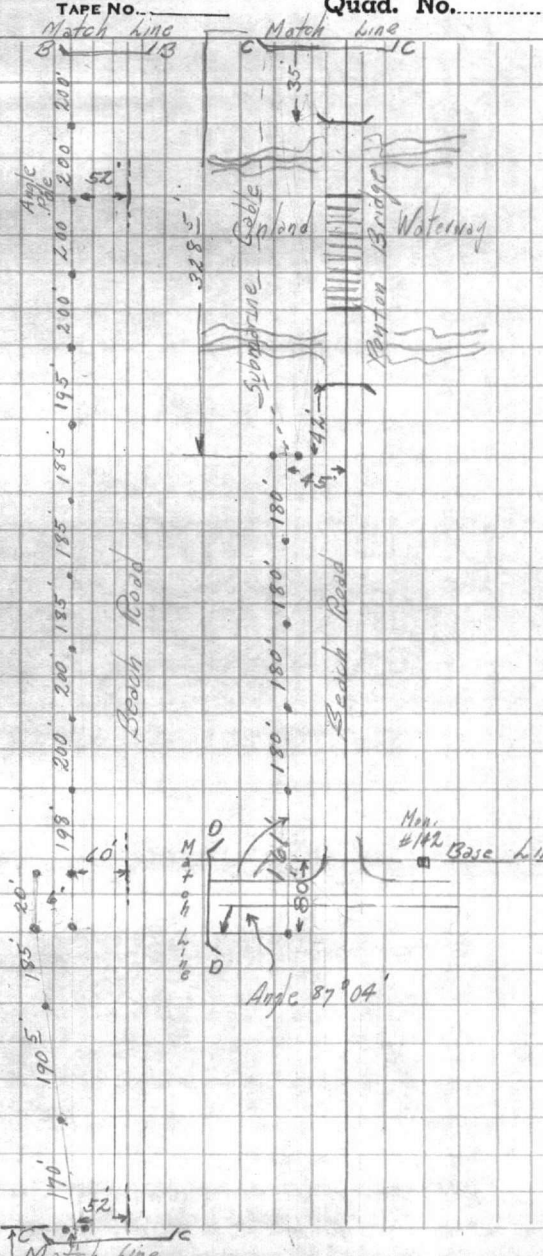

VALUABLE

OFFICE
NEW YORK



VALUABLE

SUBJECT Power Line Signal School
Onslow Beach

RETURN TO
PUBLIC WORKS
OFFICE
CAMP LEJEUNE
NEW RIVER, N. C.

FIELD PARTY

Dillon IN CHARGE
INSTRUMENT _____
NOTES _____
TAPE READ _____
TAPE OR ROD _____
TAPE OR ROD _____
INSTRUMENT NO. _____
TAPE NO. _____

WEATHER

CLEAR _____ SNOW _____
CLOUDY _____ HOT _____
WINDY _____ MODERATE _____
RAIN _____ COLD _____
FAIR _____ FOG _____

FILE No.

FLDR. No.

SHEET # 3 of 3

FIGURED BY _____
NOTES CHECKED BY _____

PLOTTED BY _____ DATE 1/1 1944

Quad. No.

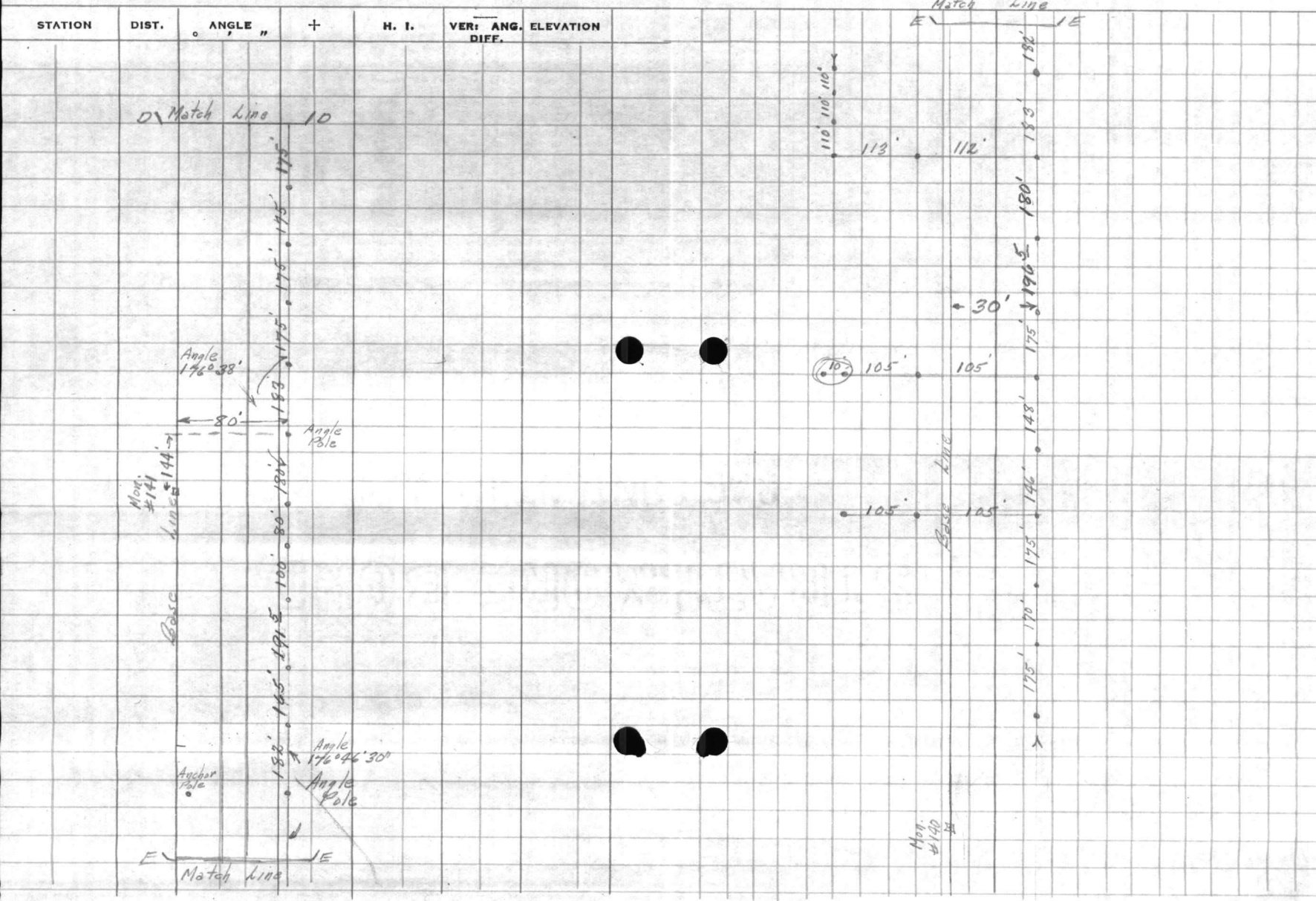

452161
452175

162457
162460
228602

AVIATION SYSTEMS

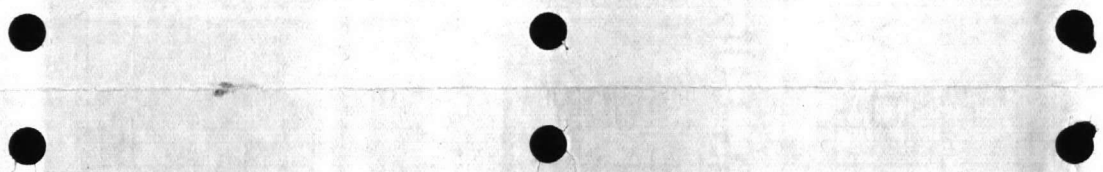

Hazel - Oct 15, 1954

Corinne Aug 12, 1955

Diana " 17, 1955

Louise Sept 19, 1955

Helene 27 Sept 1958

Donna 11 Sept 1960

Get Atl. 14 Sept 1964

[C. L. King, Civil Eng.]
Wilmington, Dist. Conf. Ch. S. Engins.
RD 3-6964

Hor.
1" = 10' Vert.

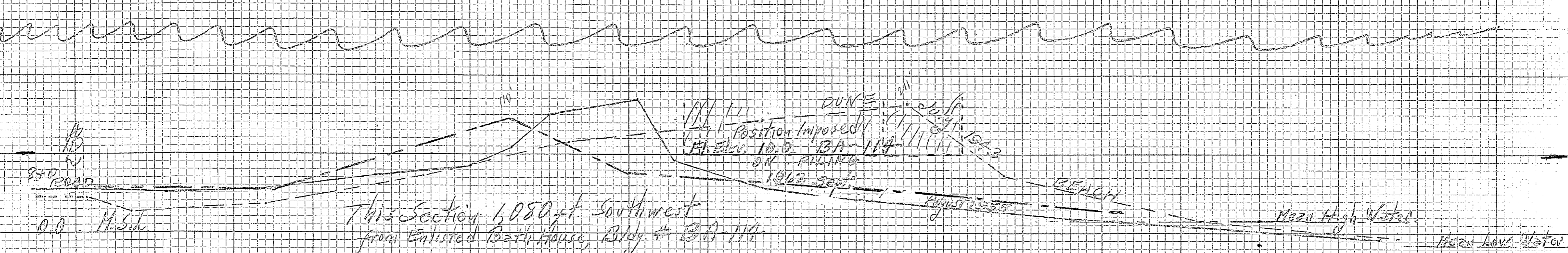
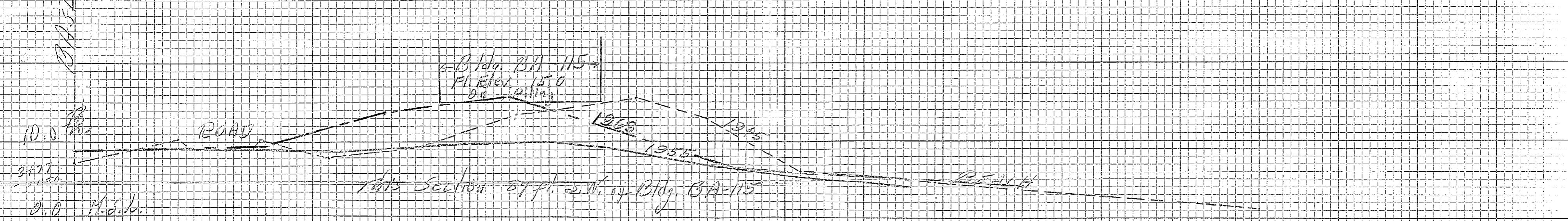
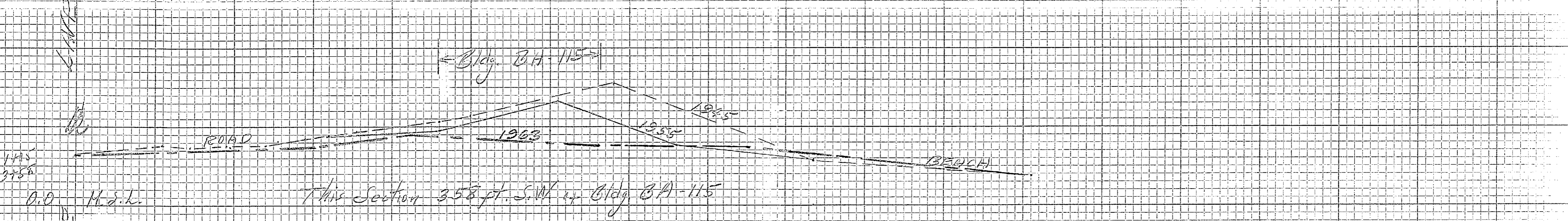
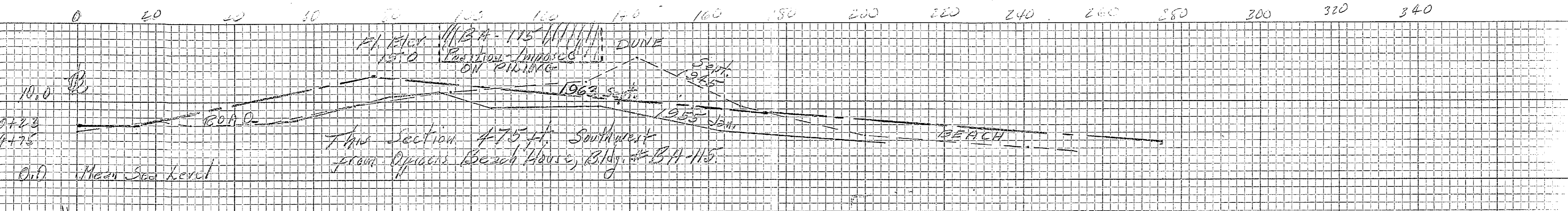

Comparative X-Section at Onslow Beach, Building Areas.
Year 1945-55 and 1943-55

Scales: 1" = 20' Horizontal and 1" = 10' Vertical

1963 Elevations taken by Maintenance Forces. T.W.B.

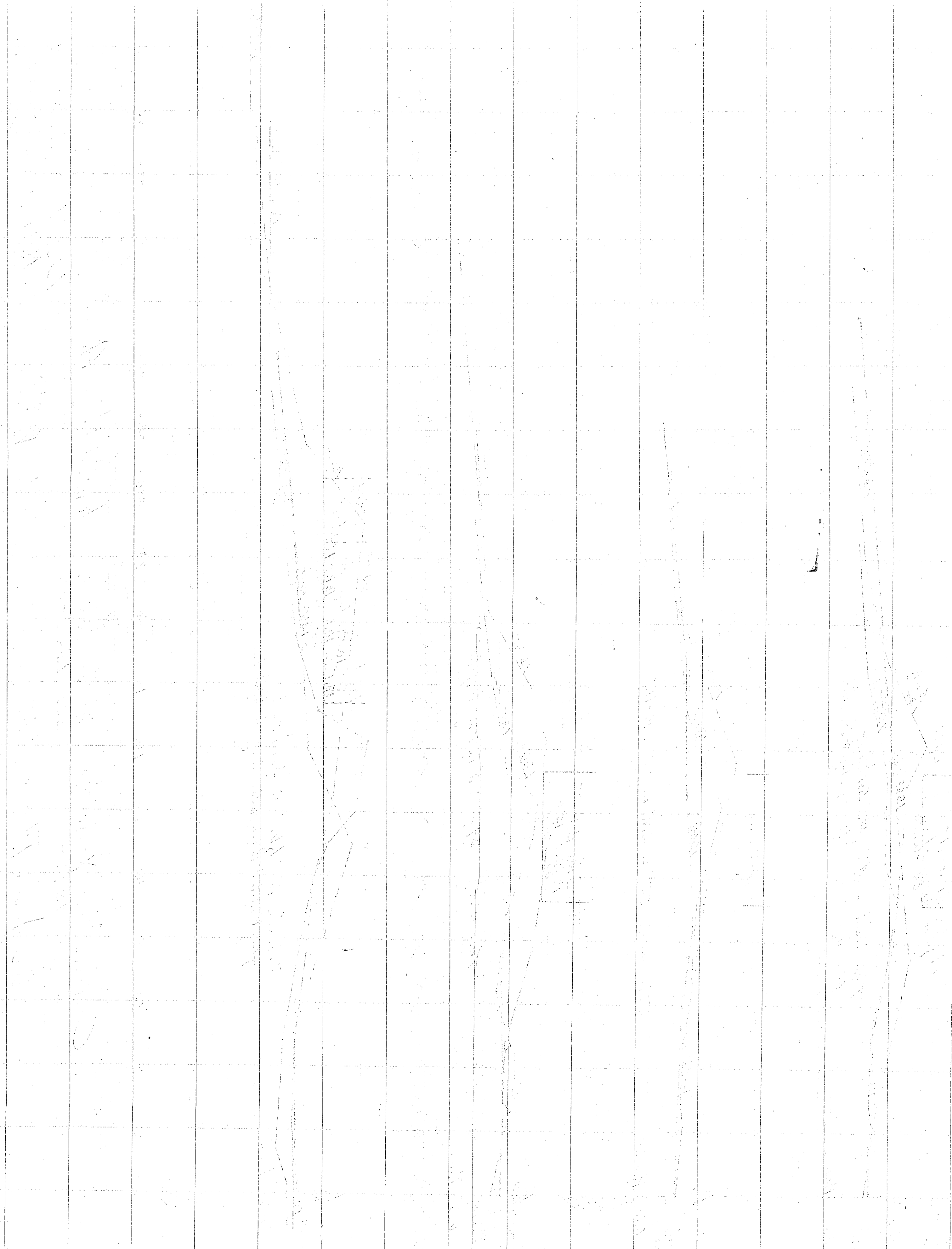

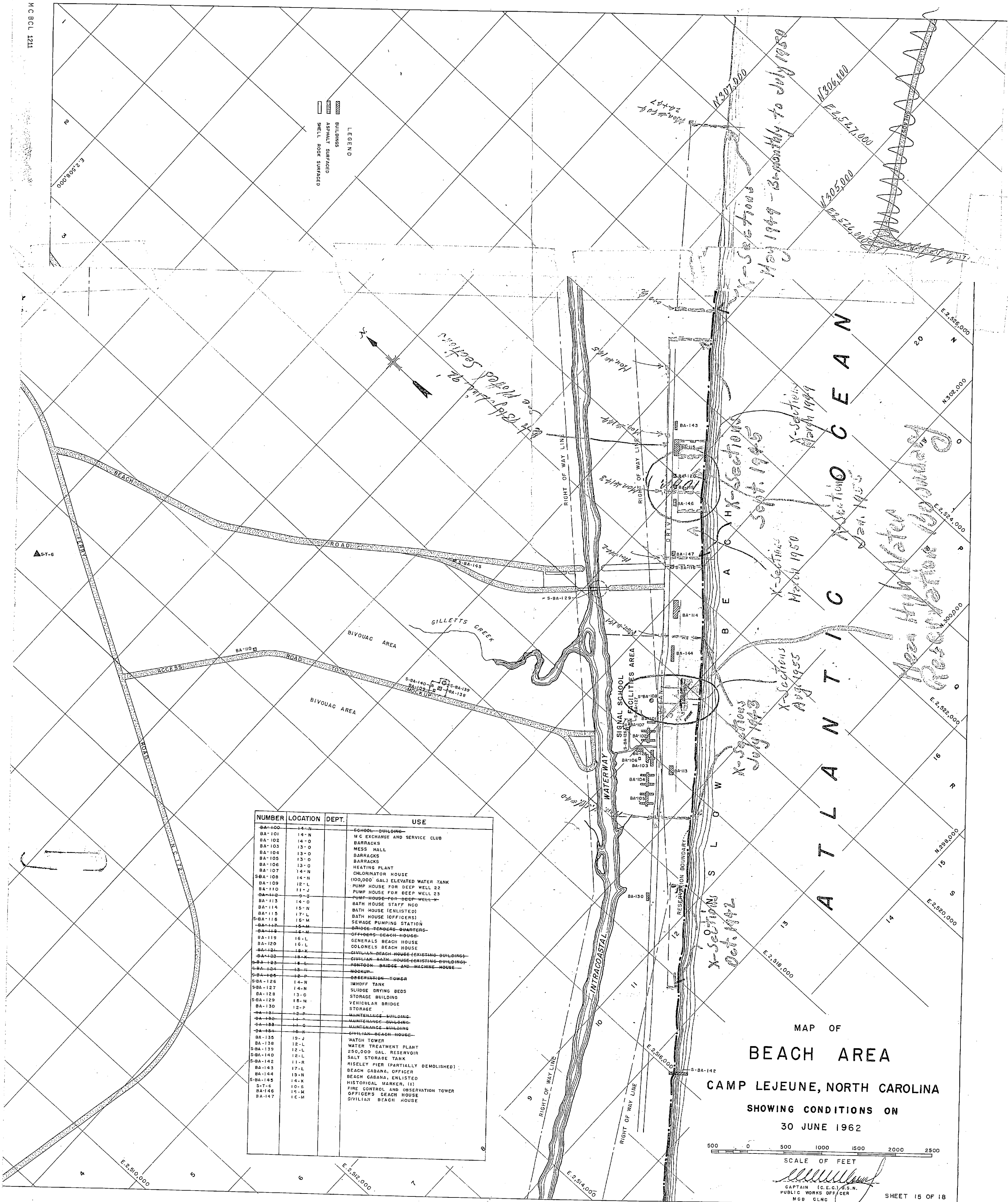

NUMBER	LOCATION	DEPT.	USE
BA-100	14-N		SCHOOL-BUILDING
BA-101	14-N		M.C. EXCHANGE AND SERVICE CLUB
BA-102	14-O		BARRACKS
BA-103	13-O		MESS HALL
BA-104	13-O		BARRACKS
BA-105	13-O		BARRACKS
BA-106	13-O		HEATING PLANT
BA-107	14-N		CHLORINATOR HOUSE
SBA-108	14-N		(100,000 GAL) ELEVATED WATER TANK
BA-109	12-L		PUMP HOUSE FOR DEEP WELL 22
BA-110	11-J		PUMP HOUSE FOR DEEP WELL 23
BA-111	9-Z		PUMP HOUSE FOR DEEP WELL 24
BA-112	16-O		BATH HOUSE (ENLISTED)
BA-113	16-O		BATH HOUSE (OFFICERS)
BA-114	17-L		BATH HOUSE (ENLISTED)
BA-115	17-L		BATH HOUSE (OFFICERS)
SBA-116	16-M		SEWAGE PUMPING STATION
BA-117	16-M		BRIDGE-TENDERS-QUARTERS
BA-118	16-M		OFFICERS-BENCH-HOUSE
BA-119	16-L		GENERALS BEACH HOUSE
BA-120	16-L		COLONELS BEACH HOUSE
BA-121	16-K		CIVILIAN-BEACH-HOUSE (EXISTING-BUILDING)
SBA-122	16-L		CIVILIAN-BEACH-HOUSE (EXISTING-BUILDING)
SBA-123	16-L		MONSOON-BRIDGE-AND-MACHINE-HOUSE
SBA-124	16-L		MOOKUP
SBA-125	16-P		OBSERVATION-TOWER
SBA-126	14-N		MIXED TANK
SBA-127	14-N		SLUDGE DRYING BEDS
BA-128	13-O		STORAGE BUILDING
SBA-129	15-N		VEHICULAR BRIDGE
BA-130	12-P		STORAGE
BA-131	12-P		MAINTENANCE BUILDING
BA-132	11-Q		MAINTENANCE BUILDING
BA-133	11-Q		MAINTENANCE BUILDING
BA-134	16-K		CIVILIAN-BEACH-HOUSE
BA-135	19-J		WATCH TOWER
BA-136	12-L		WATER TREATMENT PLANT
SBA-137	12-L		250,000 GAL. RESERVOIR
SBA-138	12-L		SALT STORAGE TANK
SBA-139	12-L		RISELEY PIER (PARTIALLY DEMOLISHED)
BA-140	17-L		BEACH CABANA, OFFICER
BA-141	17-L		BEACH CABANA, ENLISTED
SBA-142	19-N		HISTORICAL MARKER, (1)
SBA-143	14-K		FIRE CONTROL AND OBSERVATION TOWER
S-T-6	10-S		OFFICERS BEACH HOUSE
BA-144	15-M		CIVILIAN BEACH HOUSE
BA-145	16-M		CIVILIAN BEACH HOUSE

MAP OF
BEACH AREA
 CAMP LEJEUNE, NORTH CAROLINA
 SHOWING CONDITIONS ON
 30 JUNE 1962

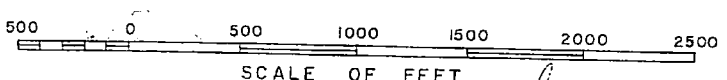

SCALE OF FEET
 CAPTAIN (C.E.C.) U.S.N.
 PUBLIC WORKS OFFICER
 MCB CLNC

221 General