



THE NATIONAL ARCHIVES  
COLLECTIONS  
SERIALS  
SECTION  
1000

VALUABLE  
PROPERTY  
RECORDS  
SECTION  
1000



2

13

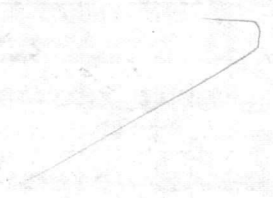

VALUABLE

SUBJECT MIDNFORD PT  
DIST. BETWEEN BLOS.  
408, 414, 415

Return To  
Public Works  
Office  
Camp Lejeune  
North Carolina

FIELD PARTY

LEARNER In Charge  
Instrument \_\_\_\_\_  
Notes \_\_\_\_\_  
Tape Read \_\_\_\_\_  
Tape or Rod \_\_\_\_\_  
Tape or Rod \_\_\_\_\_  
Instrument No. \_\_\_\_\_  
Tape No. \_\_\_\_\_

WEATHER

Clear \_\_\_\_\_  
Cloudy \_\_\_\_\_  
Windy \_\_\_\_\_  
Rain \_\_\_\_\_  
Fair \_\_\_\_\_  
Snow \_\_\_\_\_  
Hot \_\_\_\_\_  
Moderate \_\_\_\_\_  
Cold \_\_\_\_\_  
Fog \_\_\_\_\_

FILE No. \_\_\_\_\_  
Fldr. No. \_\_\_\_\_  
Sheet \_\_\_\_\_  
Date \_\_\_\_\_ 19\_\_

Notes Checked By \_\_\_\_\_  
Plotted By \_\_\_\_\_  
Quad. No. \_\_\_\_\_

Station	Dist.	Angle " "	+	H. I. Bearing	Ver. Ang. Diff.	Elevation
---------	-------	--------------	---	------------------	--------------------	-----------

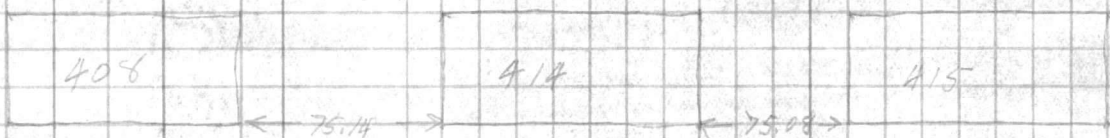

Plotted By: TDR 4-18-46  
Checked By: VLT 4-19-46







VALUABLE

SUBJECT Location of Bldg 5'  
Danford

RETURN TO  
PUBLIC WORKS  
OFFICE  
CAMP LEJEUNE  
NEW RIVER, N. C.

FIELD PARTY

Pierce IN CHARGE  
INSTRUMENT \_\_\_\_\_  
NOTES \_\_\_\_\_  
TAPE READ \_\_\_\_\_  
TAPE OR ROD \_\_\_\_\_  
TAPE OR ROD \_\_\_\_\_  
INSTRUMENT NO. \_\_\_\_\_  
TAPE NO. \_\_\_\_\_

WEATHER

CLEAR  
CLOUDY  
WINDY  
RAIN  
FAIR

SNOW  
HOT  
MODERATE  
COLD  
FOG

FILE No. ....

FLDR. No. ....

SHEET # 2 of

FIGURED BY \_\_\_\_\_

NOTES CHECKED BY \_\_\_\_\_

PLOTTED BY \_\_\_\_\_

DATE 2-27-46

Quad. No. ....

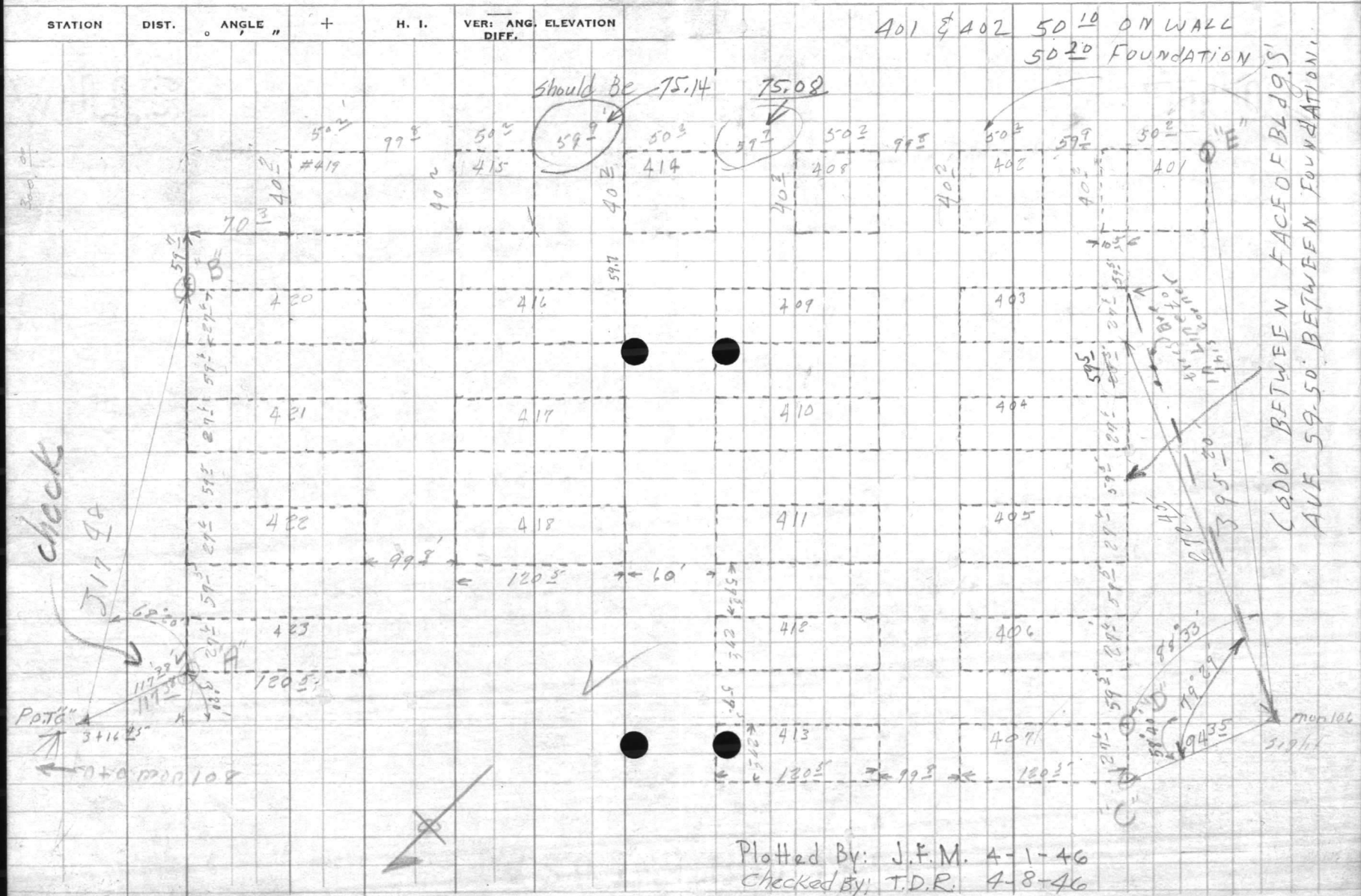

Plotted By: J.F.M. 4-1-46  
Checked By: T.D.R. 4-8-46

VALUABLE SUBJECT

SECTION  
BUREAU OF INVESTIGATION  
U.S. DEPARTMENT OF JUSTICE







VALUABLE  
RETURN TO  
PUBLIC WORKS  
OFFICE  
RIVER

MEMORANDUM FOR THE BOARD

VALUABLE

SUBJECT Location of Bldg  
# 115 Mumford Pt

RETURN TO  
PUBLIC WORKS  
OFFICE  
CAMP LEJEUNE  
NEW RIVER, N. C.

FIELD PARTY

\_\_\_\_ IN CHARGE  
\_\_\_\_ INSTRUMENT  
\_\_\_\_ NOTES  
\_\_\_\_ TAPE READ  
\_\_\_\_ TAPE OR ROD  
\_\_\_\_ TAPE OR ROD  
\_\_\_\_ INSTRUMENT NO.  
\_\_\_\_ TAPE NO.

WEATHER

CLEAR \_\_\_\_\_ SNOW \_\_\_\_\_  
CLOUDY \_\_\_\_\_ HOT \_\_\_\_\_  
WINDY \_\_\_\_\_ MODERATE \_\_\_\_\_  
RAIN \_\_\_\_\_ COLD \_\_\_\_\_  
FAIR \_\_\_\_\_ FOG \_\_\_\_\_

FILE No. ....

FLDR. No. ....

SHEET # 1 of

FIGURED BY \_\_\_\_\_

NOTES CHECKED BY \_\_\_\_\_

PLOTTED BY \_\_\_\_\_

DATE 3-1-1946

Quad. No. ....

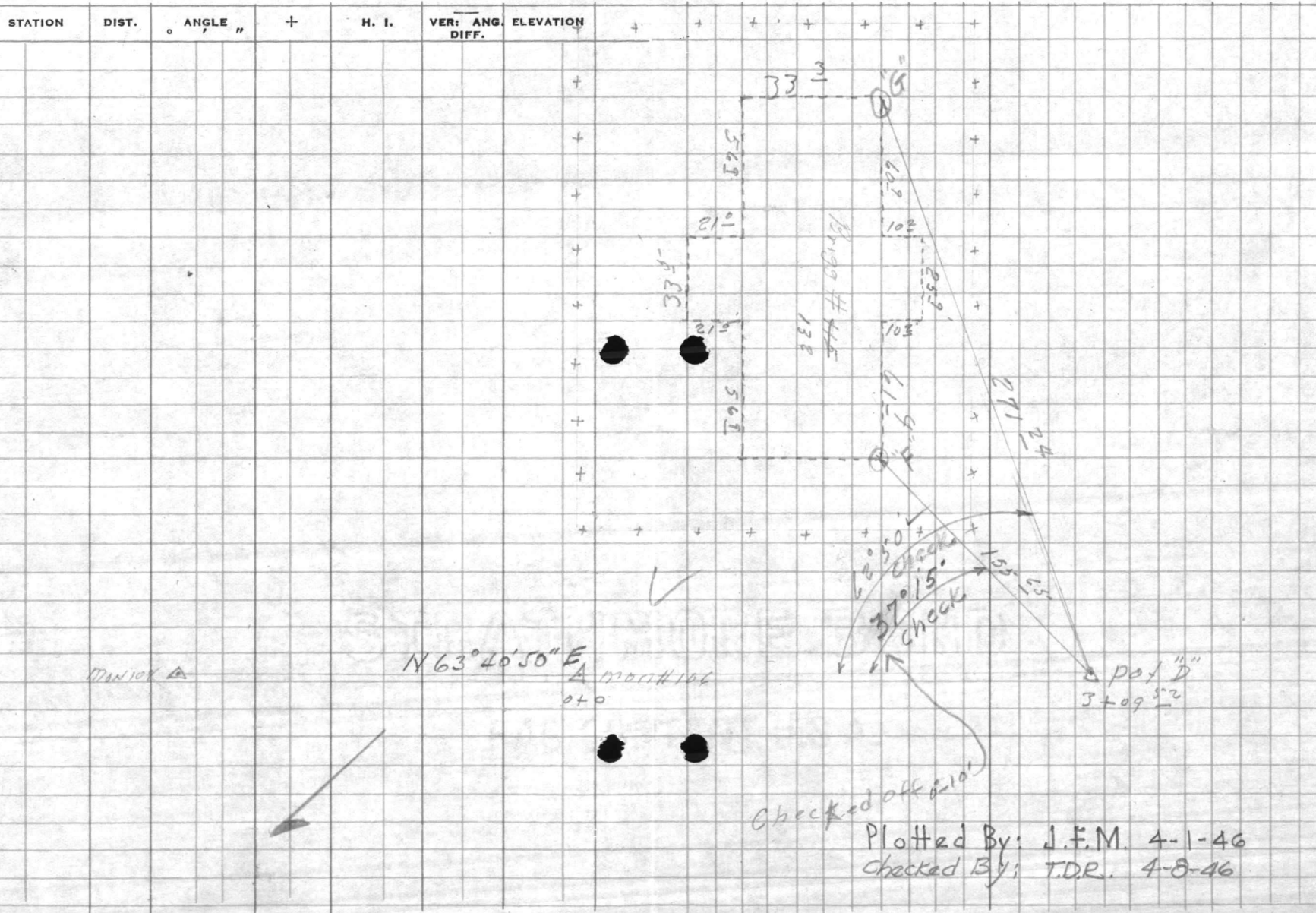

71 45  
68 30  
8 15  
4 4 34  
5 49

DESIGN  
MATERIALS

REVISIONS

DATE  
BY  
CHECKED  
APPROVED

DATE  
BY  
CHECKED  
APPROVED

REV. NO.





THE NO.

REVENUE  
OFFICE

CHARGE  
WITH

SUBJECT

VALUATION

REVENUE  
OFFICE

REVENUE OFFICE

PUBLIC WORKS DEPARTMENT  
Camp Lejeune, North Carolina  
Survey Department

File 99 P d U  
Quadrangle 99  
Date 3/1/46  
Sheet #1 of     

Traverse Computation  
Description

*Building Co-ordinates Montford Pt. Camp # 3*

Station	Distance	Bearing	Cosine	Sine	Latitude	Departure	Y Coordinate North	X Coordinate East
Mon # 109 from Mon # 136		S63°40'50"W					362,903.91	2,480,018.62
S.E. Cor. of Southwest Pier on Water Tank	89.48'	S56°06'20"W	557667	830063	51.90	44.27	362,852.01	2,479,944.35
N.E. " " " " "	95.66'	S85°39'20"W	075753	997127	7.25	95.38	362,896.66	2,479,923.24
Center of 150,000 Gal. Water Tank.	92.39'	S71°18'20"W	32052	94724	29.61	87.52	362,874.30	2,479,931.10
Mon # 108 from Mon # 106		N63°40'50"E					362,527.23	2,479,257.05
P.O.T. "A" 1+16.28	116.28'	"	4433733	8963383	51.55	104.73	362,578.78	2,479,361.78
N.E. Cor. of Bldg. # 605 ✓	71.2'	S58°05'W	52869	84882	37.64	60.44	362,541.14	2,479,300.84
S.E. " " Bldg. # 601	401.45'	S16°11'10"E	9603567	2787567	385.53	111.91	362,193.25	2,479,473.19
N.W. " " Bldg. # 611 ✓	85.4'	N6°14' W	99409	10858	84.89	9.78	362,663.67	2,479,352.50
P.O.T. "B" 5+19.03	402.75'	N63°40'50"E	4433733	8963383	178.57	361.00	362,757.35	2,479,727.78
N.W. Cor. of Bldg. # 623 ✓	84.72'	N7°38'40"W	991133	1330233	83.97	11.77	362,841.32	2,479,711.01
S.W. " " " # 619 ✓	322.08'	S31°10'10"E	8556433	5175717	275.58	166.70	362,481.77	2,479,888.98
S.E. " " " # 613 ✓	401.55'	S15°53'40"E	9617667	2738667	386.20	109.97	362,371.15	2,479,832.75
S.W. " " " # 618 ✓	108.38'	N68°37'40"W	3657794	9307016	39.64	100.87	362,796.99	2,479,621.41
N.W. " " " # 673 ✓	84.77'	N7°38'40"W	991133	1330233	83.97	11.77	362,841.32	2,479,711.01
P.O.T. "C" 3+16.45	316.45'	N63°40'50"E	4433754	8963360	140.31	283.64	362,382.72	2,479,788.25
S.W. Cor. of Bldg. # 474 ✓	120.65'	S19°37'40"E	9423873	3345380	113.70	40.36	362,293.22	2,479,627.71
N.E. " " " " ✓	183.57'	S75°31'40"E	2499106	9687689	45.87	177.74	362,341.35	2,479,154.89
P.O.T. "A" from # 106	396.20'	N63°40'50"E			341.19	101.40	362,578.78	2,479,361.78
S.W. Cor. of Bldg. 606 ✓	401.45'	S30°33'10"E	8611613	5083318	345.71	204.07	362,233.07	2,479,365.33

Wrong Dist

Plotted By: J.F.M. 4-1-46  
Checked By: T.D.R. 4-8-46





PUBLIC WORKS DEPARTMENT  
Camp Lejeune, North Carolina  
Survey Department

File \_\_\_\_\_  
Quadrangle \_\_\_\_\_  
Date \_\_\_\_\_  
Sheet \_\_\_\_\_ of \_\_\_\_\_

Traverse Computation  
Description

Station	Distance	Bearing	Cosine	Sine	Latitude	Departure	Y Coordinate North	X Coordinate East
Mon # 106 to 108		S 63° 40' 50" W					361,984.37	2,478,159.41
Mon # 106 to P.O.T. "D"	309.57	S 63° 40' 50" W	4433754	8963360	137.73	277.43	361,847.09	2,477,881.98
=	=	=	=	=	=	=	=	=
P.T. #1 to #2		N 66° 09' 16" E					367,486.08	2,480,118.73
S.W. Cor. Heating plant 605	68.85	N 59° 16' 14" W	5109847	8595898	35.18	59.18	367,571.60	2,480,059.55
S.E. Cor. " " "	107.60	N 3° 54' 16" E	9976790	0680927	107.35	7.33	367,593.30	2,480,176.06
=	=	=	=	=	=	=	=	=
P.O.T. "C" to #106		S 63° 40' 50" W					367,386.92	2,478,973.41
"H" Cor. of Bldg. #423	117.38	S 60° 70' 50" W	4947426	8690395	58.07	107.01	367,528.85	2,478,871.40
"B" Cor. " " # 420	317.48	S 4° 39' 10" E	9967046	0811171	316.43	25.75	367,070.49	2,478,999.16
Mon. # 106 to P.O.T. "C"		N 63° 40' 50" E		8963360			361,984.37	2,478,159.41
"C" Cor. of Bldg. # 407	94.35	N 5° 00' 50" E	9961693	0873977	93.99	8.24	367,078.31	2,478,167.65
"E" Cor. of " # 401	395.70	S 77° 46' 10" E	8848296	4659148	349.68	184.13	361,634.64	2,478,343.54
"P.O.T. "D" to #106 = 101		N 63° 40' 50" E		8963360			361,847.09	2,477,881.98
"F" Cor. of Bldg. # 137	155.65	S 78° 44' 10" E	1953281	9807379	30.40	152.65	361,816.69	2,478,034.63
"G" " " " # 137	271.74	S 53° 29' 10" E	5950176	8037126	161.39	218.00	361,685.70	2,478,099.98
"H" " " " NCO. club	358.77	S 57° 48' 10" E	6045605	7965597	216.90	285.78	361,630.19	2,478,167.76
"I" " " " " "	364.88	S 44° 34' 10" E	7124004	7071732	259.94	258.03	361,587.15	2,478,140.01
"J" " " " Theater	266.65	S 72° 55' 10" E	9987071	0509318	266.30	13.58	361,580.79	2,477,895.56
"K" " " " " "	346.38	S 18° 43' 50" W	9470392	3711181	328.03	111.23	361,519.06	2,477,770.75

Plotted By: J.F.M. 4-1-46  
Checked By: T.D.R. 4-8-46

#626

#114

129

STATE OF NEW YORK  
OFFICE OF THE COMMISSIONER OF EDUCATION  
BUREAU OF STATISTICS

1911  
1912  
1913  
1914  
1915  
1916  
1917  
1918  
1919  
1920  
1921  
1922  
1923  
1924  
1925  
1926  
1927  
1928  
1929  
1930

1911  
1912  
1913  
1914  
1915  
1916  
1917  
1918  
1919  
1920  
1921  
1922  
1923  
1924  
1925  
1926  
1927  
1928  
1929  
1930

Year	Elementary	Intermediate	High	Total	Per Cent	Notes
1911						
1912						
1913						
1914						
1915						
1916						
1917						
1918						
1919						
1920						
1921						
1922						
1923						
1924						
1925						
1926						
1927						
1928						
1929						
1930						







**VALUABLE**

SUBJECT Bench Levels  
Heating and Heat Facilities  
Montford Point

RETURN TO  
 PUBLIC WORKS  
 OFFICE  
 CAMP LEJEUNE  
 NORTH CAROLINA

FIELD PARTY  
Dennis IN CHARGE  
 \_\_\_\_\_ INSTRUMENT  
 \_\_\_\_\_ NOTES  
 \_\_\_\_\_ TAPE READ  
 \_\_\_\_\_ TAPE OR ROD  
 \_\_\_\_\_ TAPE OR ROD  
 \_\_\_\_\_ INSTRUMENT NO.  
 \_\_\_\_\_ TAPE NO.

WEATHER  
 CLEAR \_\_\_\_\_ SNOW \_\_\_\_\_  
 CLOUDY \_\_\_\_\_ HOT \_\_\_\_\_  
 WINDY \_\_\_\_\_ MODERATE \_\_\_\_\_  
 RAIN \_\_\_\_\_ COLD \_\_\_\_\_  
 FAIR \_\_\_\_\_ FOG \_\_\_\_\_  
 FIGURED BY \_\_\_\_\_  
 NOTES CHECKED BY \_\_\_\_\_  
 PLOTTED BY \_\_\_\_\_  
 FILE No. 99-P  
 FLDR. No. \_\_\_\_\_  
 SHEET #1 of 2  
 DATE 1/22/1959  
 Quad. No. \_\_\_\_\_

STATION	DIST.	ANGLE ° ' "	+	H. I. BEARING	VER: ANG. DIFF.	ELEVATION	
B.m.			5 38	25 37	✓	19.99	MON # 106 SOUTH BLDG # M-406
B.m. #1			3 72	25 15	✓	3.94 <u>21.43</u>	BACKBOLT FIRE HYD. NORTH END BLDG # M-406
B.m. #2			2 49	23 71	✓	3.93 <u>21.22</u>	BACKBOLT FIRE HYD. SOUTHWEST COR. BLDG. M-423
T.P.			6 37	24 83	✓	5 25 <u>18.46</u>	
B.m. #3			3 62	24 10	✓	4 35 <u>20.48</u>	NAIL IN TEL. POLE SOUTHWEST COR. BLDG # M-609
B.m.			3 82	23 79	73	4 19 <u>19.91</u>	← change to 19.91 MON # 108 WEST SIDE BLDG # M-605
B.m.			4 75	23 37	50	25 5.23 <u>18.56</u>	NORTHWEST COR. SLAB AT BASE OF WATER TANK MONTFORD PT.
B.m.			3 27	23 25	92	19 3 33 <u>19.98</u>	S.E. COR. FOUND. BLDG # M-614
B.m.			2 82	23 32	44	26 2 75 <u>20.50</u>	S.E. COR. FOUND. BLDG # M-615
T.P.			4 33	23 84	11	23 4 15 <u>19.17</u>	COR. STOOD NORTH END BLDG # M-623
B.m.			7 16	23 77	49	6 5 C 95 <u>16.55</u>	← Hold 16.49 MON # 109
B.m.					18.97	4 C 8 <u>19.03</u>	← Hold 18.97 18.90 SPIKE IN P.D. NEAR HEATING PLANT.



STATION

DATE  
TIME  
PLACE

STATION DIST. BEARING H. I. VERT. ANG. ELEVATION

WILLIAMS

IN CHARGE

STATEMENT

DATE

TAB. NO.

TAB. PRISON

TAB. OR TOP

NUMBER NO.

TAB. NO.

WESTON

IN CHARGE

STATEMENT

DATE

TAB. NO.

TAB. PRISON

TAB. OR TOP

NUMBER NO.

TAB. NO.

CLIP 401

IN CHARGE

STATEMENT

DATE

TAB. NO.

TAB. PRISON

TAB. OR TOP

NUMBER NO.

TAB. NO.

VALUABLE

SUBJECT \_\_\_\_\_

RETURN TO  
PUBLIC WORKS  
OFFICE  
CAMP LEJEUNE  
NORTH CAROLINA

FIELD PARTY

\_\_\_\_\_  
IN CHARGE  
\_\_\_\_\_  
INSTRUMENT  
\_\_\_\_\_  
NOTES  
\_\_\_\_\_  
TAPE READ  
\_\_\_\_\_  
TAPE OR ROD  
\_\_\_\_\_  
TAPE OR ROD  
\_\_\_\_\_  
INSTRUMENT NO.  
\_\_\_\_\_  
TAPE NO.

WEATHER

CLEAR  
CLOUDY  
WINDY  
RAIN  
FAIR  
SNOW  
HOT  
MODERATE  
COLD  
FOG  
FIGURED BY \_\_\_\_\_  
NOTES CHECKED BY \_\_\_\_\_  
PLOTTED BY \_\_\_\_\_

FILE No. \_\_\_\_\_

FLDR. No. \_\_\_\_\_

SHEET #2042

DATE 1/22/1959

Quad. No. \_\_\_\_\_

STATION	DIST.	ANGLE ° ' "	+	H. I. BEARING	VER. ANG. DIFF.	ELEVATION	
B.m.		4 40	23	30 <sup>37</sup> ✓	18	97 <sup>90</sup> ✓	NAIL IN P.P. IBM-29
B.m.		6 86	23	27 <sup>346</sup>	89	15 <sup>48</sup> ✓	MON. # 109
B.m.		4.81	23	22 <sup>29</sup>	4 86	18 <sup>48</sup> ✓	COR. SLAB WATER TANK
T.P.		4.03	23	05 <sup>12</sup>	4 20	10 <sup>09</sup> ✓	
B.M.		3.00	22	34 <sup>91</sup>	3.21	10 <sup>91</sup> ✓	COR. FOUND. 616
B.M.		2.22	22	58 <sup>65</sup>	2.48	20 <sup>43</sup> ✓	COR. " 615
T.P.		3.76	23	39 <sup>46</sup>	2.95	19 <sup>70</sup> ✓	
MON 109		4.17	24	04 <sup>08</sup>	3.55	19 <sup>91</sup> ✓	
B.M.		3.19	23	61 <sup>68</sup>	3.59	20 <sup>49</sup> ✓	TEL POLE COR BLDG. 609
T.P.		5.37	24	34 <sup>41</sup>	4.64	19 <sup>04</sup> ✓	
B.M.		3.55	24	69 <sup>76</sup>	3.20	21 <sup>21</sup> ✓	ON F.H. BY BLDG 423
B.M.		3.62	24	07 <sup>25.04</sup>	3.34	21 <sup>42</sup> ✓	" " " " 406
B.M.					5.06	19 <sup>98</sup> ✓	MON # 106
						19.99	





VA. TABLE

SUBJECT check Levels AT  
MON. Point.

RETURN TO  
PUBLIC WORKS  
OFFICE  
CAMP LEJEUNE  
NORTH CAROLINA

FIELD PARTY

Kellum IN CHARGE  
INSTRUMENT  
NOTES  
TAPE READ  
TAPE OR ROD  
TAPE OR ROD  
INSTRUMENT NO.  
TAPE NO.

WEATHER

CLEAR  
CLOUDY  
WINDY  
RAIN  
FAIR  
SNOW  
HOT  
MODERATE  
COLD  
FOG  
FIGURED BY  
NOTES CHECKED BY  
PLOTTED BY

FILE No. \_\_\_\_\_  
FLDR. No. \_\_\_\_\_  
SHEET 1-0f  
DATE 1-23-59

check Levels  
Quad. No. \_\_\_\_\_

STATION	DIST.	ANGLE ° ' "	+	H. I. BEARING	VER. ANG. DIFF.	ELEVATION
B.M.						19.99
		5.26		25.25		
T.P.		3.32		25.83	2.74	22.51
B.M. (T.P.)		3.56		25.44	3.95	21.88
T.P.		4.07		25.61	3.90	21.54
T.P.		5.29		26.56	4.34	21.27
T.P.		3.96		25.75	4.77	21.79
T.P.		4.33		25.22	4.86	20.89
T.P.		1.16		21.25	5.13	20.09
B.M. (T.P.)		4.41		23.38	2.28	18.97
B.M.					6.89	16.49

U.S.M.C. MON. #106

spike in steam pole s.w. cor. Bldg. 4-129

(18.90)

nail in transformer pole near Heating plant

(16.40)

U.S.M.C. MON. #109

Verifies Point 1/22/59  
by Dennis

RETURN TO  
PUBLIC WORKS  
DIVISION  
CITY OF BOSTON  
COMMUNICATIONS

STATION  
DATE

BEARING  
DIP

CHIT. 121  
LIV. 101

TA-110  
RUSHING NO.

TYPE OF ROD

TYPE OF WIRE

TWO'S LEAD

RECORDED BY

NOTED BY

DATE

TIME

W. BATHEN

FILE NO.







THE

REMARKS  
WIND  
TEMP  
PRESSURE  
HUMIDITY  
SEA  
CLOUDS  
VISIBILITY  
CURRENTS  
REMARKS

FIELD NO.  
DATE  
TIME  
LATITUDE  
LONGITUDE  
LOCAL TIME  
WIND DIRECTION  
WIND FORCE  
WIND VELOCITY  
TEMP AIR  
TEMP SURFACE  
TEMP WATER  
TEMP DEW POINT  
PRESSURE BAROMETRIC  
PRESSURE ALTITUDE  
HUMIDITY RELATIVE  
HUMIDITY MIXED  
SEA STATE  
CLOUDS  
VISIBILITY  
CURRENTS  
REMARKS

STATION

DATE  
TIME  
LATITUDE  
LONGITUDE  
LOCAL TIME

WIND DIRECTION  
WIND FORCE  
WIND VELOCITY

TEMP AIR  
TEMP SURFACE  
TEMP WATER  
TEMP DEW POINT

PRESSURE BAROMETRIC  
PRESSURE ALTITUDE  
HUMIDITY RELATIVE  
HUMIDITY MIXED



**VALUABLE**

SUBJECT ELEV. WATER TANK  
# S-M-624 MONTFORD  
PT.

RETURN TO  
PUBLIC WORKS  
OFFICE  
CAMP LEJEUNE  
NORTH CAROLINA

FIELD PARTY

DENNIS IN CHARGE  
\_\_\_\_ INSTRUMENT  
\_\_\_\_ NOTES  
\_\_\_\_ TAPE READ  
\_\_\_\_ TAPE OR ROD  
\_\_\_\_ TAPE OR ROD  
\_\_\_\_ INSTRUMENT NO.  
\_\_\_\_ TAPE NO.

WEATHER

CLEAR  
CLOUDY  
WINDY  
RAIN  
FAIR  
SNOW  
HOT  
MODERATE  
COLD  
FOG

FILE No. 99-P  
FLDR. No. \_\_\_\_\_  
SHEET 1 of 1  
DATE 9-15-58

Quad. No. \_\_\_\_\_

STATION	DIST.	ANGLE ° ' "	+	H. I. BEARING	VER: ANG. DIFF.	ELEVATION
B.m				6623 06	✓	16 40
B.m.				45722.98	✓	4 65 18 41
B.m.					✓	6 58 19 40

MDN. # 109

DN N.W. COR. CONC. SLAB @ TANK # S-M-624

B.m. # 109

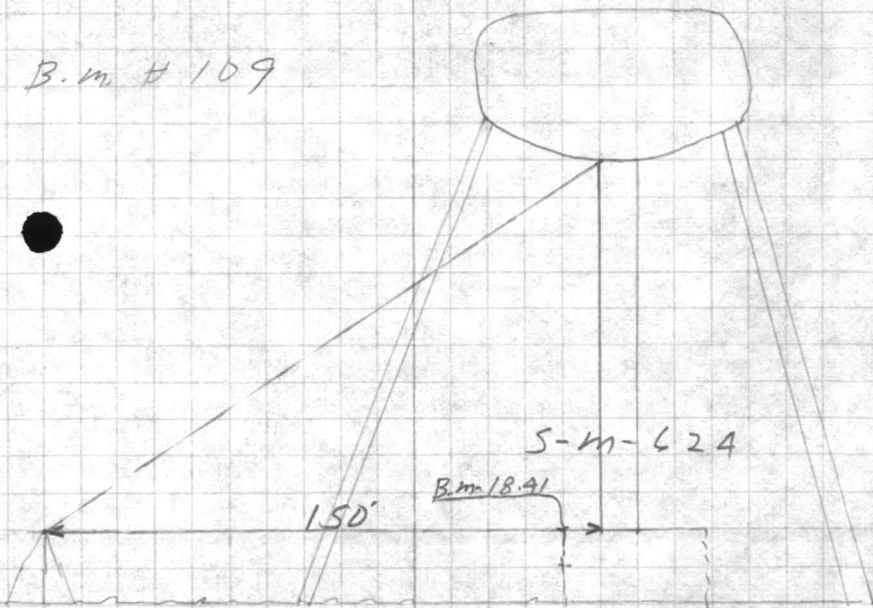

Questionable

~~150' + 21 38' = 532~~

16.76 Petcock elev.

92.50

109.26

Use 109.0 for Overflow Elevation

~~T&N. 39 660 X 150' = 58.49~~

~~+ 532~~

~~+ 18.41~~

~~Elev 83.22~~

BOTTOM OF TANK

STATION  
DATE  
TIME  
OFFICER  
CAMP  
MOUNTAIN CAROLINA

SUBJECT

FIELD PARTY

WEATHER

IN CHARGE

INSTRUMENT

NOTES

TAPE READ

TAPE OR LOG

TAPE OR LOG

INITIAL NO.

TAPE NO.

WIND

MOON

TEMP.

REL. HUM.

WIND DIR.

WIND S.P.

WIND V.

FIELD NO.

DATE

TIME

OFFICER

CAMP

MOUNTAIN

CAROLINA



**VALUABLE**

RETURN TO  
PUBLIC WORKS  
OFFICE  
CAMP LEJEUNE  
NORTH CAROLINA

SUBJECT BENCH MARK FOR  
PROPOSED WELL MONT.  
FORD PT. AREA

FIELD PARTY  
DENNIS IN CHARGE  
\_\_\_\_\_  
INSTRUMENT  
\_\_\_\_\_  
NOTES  
\_\_\_\_\_  
TAPE READ  
\_\_\_\_\_  
TAPE OR ROD  
\_\_\_\_\_  
TAPE OR ROD  
\_\_\_\_\_  
INSTRUMENT NO. \_\_\_\_\_  
TAPE NO. \_\_\_\_\_

WEATHER  
CLEAR \_\_\_\_\_  
CLOUDY \_\_\_\_\_  
WINDY \_\_\_\_\_  
RAIN \_\_\_\_\_  
FAIR \_\_\_\_\_  
SNOW \_\_\_\_\_  
HOT \_\_\_\_\_  
MODERATE \_\_\_\_\_  
COLD \_\_\_\_\_  
FOG \_\_\_\_\_  
FIGURED BY \_\_\_\_\_  
NOTES CHECKED BY \_\_\_\_\_  
PLOTTED BY \_\_\_\_\_

FILE No. 99-P  
FLDR. No. \_\_\_\_\_  
SHEET 1 of 1  
DATE 11-2 19\_\_

Quad. No. \_\_\_\_\_

STATION	DIST.	ANGLE ° ' "	+	H. I. BEARING	VER: ANG. DIFF.	ELEVATION	
B.m.			✓	5 51 25.62		20 11	FL. WELL # 627
T.P.			✓	5 02 27.59	3 65	21.97	
T.P.			✓	5 73 25.05	8 27	19.32	
B.m.			✓	1 94 25 18	1 81	23.24	SPIKE IN 12" PINE
T.P.			✓	8 06 27 30	5 94	19.24	
T.P.			✓	3 63 25.57	5 36	21.94	
B.m.			✓		5.47 20.10	(2011)	FL. WELL # 627

TABLET

TABLET

TABLET

WEATHER

FIELD PARTY

WIND

IN CHARGE

DATE

INSTRUMENT

NO. OF

REMARKS

TAPE READ

NOTE

TAPE ON

CHART

INSTRUMENT NO.

BY

TAPE NO.

NO.







VALLEY

SUBJECT

Public Works  
Office  
Comptroller  
Local Council

Station Dist. + ROAD  
H.I. V. AND Elevation  
Bearing DIR.

FIELD PARTY

Lead George  
Instrument  
Notes  
Tape Head  
Tape by Rod  
Tape on Rod  
Tape No.

WEATHER

Clear  
Cloud  
Wind  
Rain  
Fog  
Thunder  
Notes Checked By  
Plotted By

FILE No.

FILE No.

DATE

DATE

FILE No.



**VALUABLE**

SUBJECT Floor Elev's.  
Montford Point  
Ared.

RETURN TO  
 PUBLIC WORKS  
 OFFICE  
 CAMP LEJEUNE  
 NORTH CAROLINA

**FIELD PARTY**

Morton IN CHARGE  
 \_\_\_\_\_ INSTRUMENT  
 \_\_\_\_\_ NOTES  
 \_\_\_\_\_ TAPE READ  
 \_\_\_\_\_ TAPE OR ROD  
 \_\_\_\_\_ TAPE OR ROD  
 \_\_\_\_\_ INSTRUMENT NO.  
 \_\_\_\_\_ TAPE NO.

**WEATHER**

CLEAR  
 CLOUDY  
 WINDY  
 RAIN  
 FAIR

SNOW  
 HOT  
 MODERATE  
 COLD  
 FOG

FILE No. 99-U  
 FLDR. No. \_\_\_\_\_  
 SHEET 1 of 1  
 DATE 12-11-57

FIGURED BY \_\_\_\_\_  
 NOTES CHECKED BY \_\_\_\_\_  
 PLOTTED BY \_\_\_\_\_  
 Quad. No. \_\_\_\_\_

STATION	DIST.	ANGLE " "	+	H. I. BEARING	VER: ANG. DIFF.	ELEVATION	
B.M.			7.55	2560	✓	18.85	Int. Pamlico & Neuse Rds.
						3.16	22.44 ✓ Floor Bldg. # 174
B.M.			7.55	1805			
B.M.			4.84	2647	✓	21.63	Nail Int. Montford Landing Rd. & North Drive To Water Treatment Plant.
						4.85	21.62 ✓ Floor Bldg. # 141. Well House
B.M.			4.84	21.63			
B.M.			3.52	2515	✓	21.63	Nail Int. Montford Landing Rd. & North, Drive To Water Treatment Plant.
						3.87	21.28 ✓ Floor Bldg. # 170
B.M.			3.52	21.63	✓		
B.M.			5.35	2559	✓	20.24	Int. Wilson Drive & Montford Landing Rd.
						5.42	20.17 ✓ Floor Bldg. # 159
B.M.			5.35	20.24			

VALUABLE

RETURN TO  
FIELD WORKS  
OFFICE  
LAW OFFICE  
BETHLEHEM

SECTION DATE

ANGEL

SEARCHED INDEXED

FILED AND RECEIVED

FIELD PARTY

IN CHARGE

EXAMINER

DATE

TAPES

TAPES ON LOG

TAPES ON LOG

TAPES

WARRANT

FOR

SEARCH

OF

RECORDS

AND

COPIES

HEREOF

FILE NO.

DATE

BY

NAME