

VALUABLE

RETURN TO
PUBLIC WORKS
OFFICE
CAMP LEJEUNE
NORTH CAROLINA

SUBJECT COORDINATION OF
BLDG. F.C. 8 & 9 FRENCH
CREEK AREA

FIELD PARTY

DENNIS IN CHARGE
MORON INSTRUMENT
MORON NOTES
BATSON TAPE READ
DENNIS TAPE OR ROD
INSTRUMENT No. _____
TAPE No. _____

WEATHER

CLEAR _____ SNOW _____
CLOUDY _____ HOT _____
WINDY _____ MODERATE _____
RAIN _____ COLD _____
FAIR _____ FOG _____
FIGURED BY _____
NOTES CHECKED BY _____
PLOTTED BY _____

FILE No. 160 W
FLDR. No. _____
SHEET 1 of 1
DATE 2/24 1955

Quad. No. _____

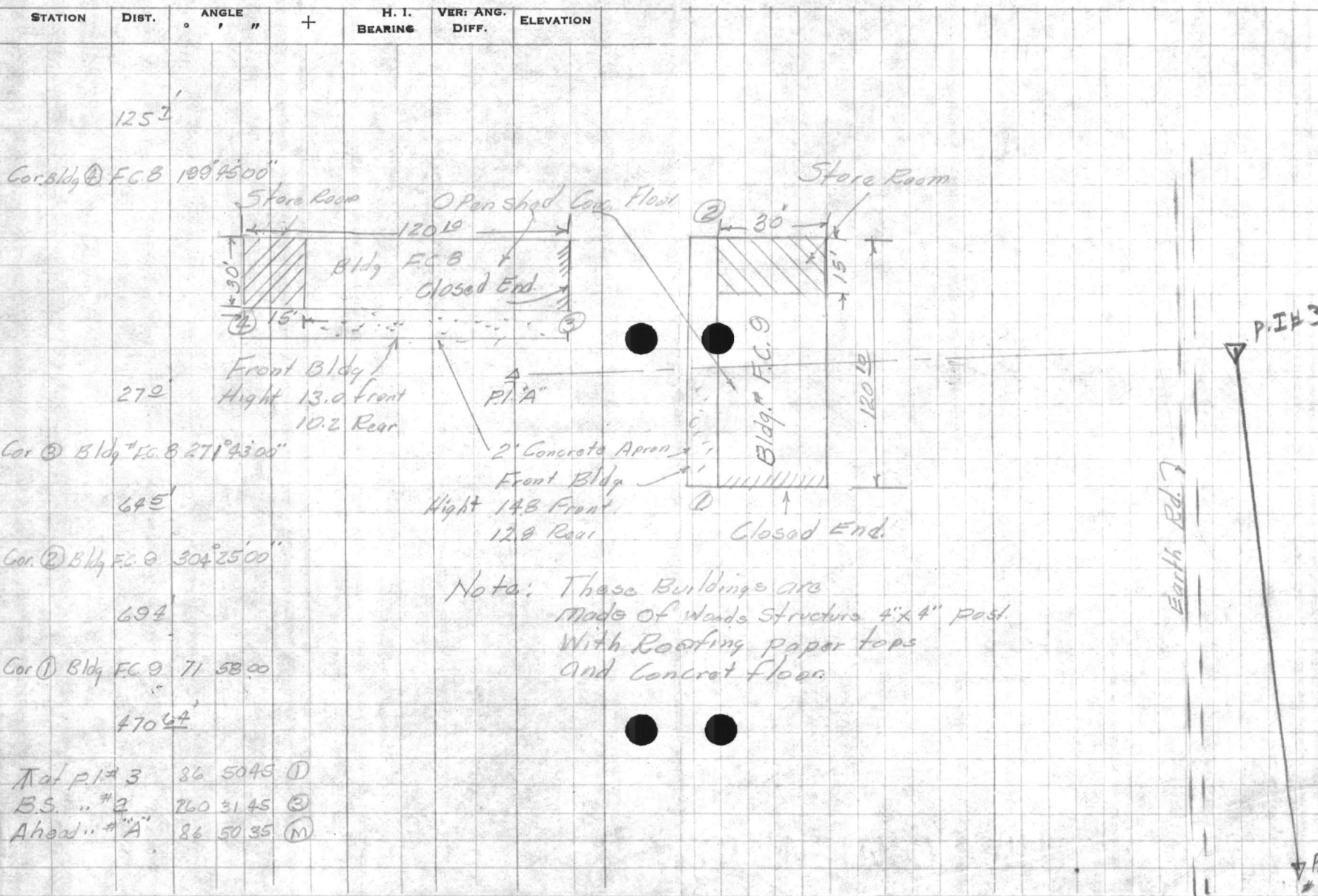

~~86° 01' 00"~~

✓
86 50 45

260 31 45

$$\begin{array}{r} 3 \overline{) 260} 86 \\ \underline{24} \\ 20 \\ \underline{18} \\ 2 \end{array}$$

$$\begin{array}{r} 120 \\ 80 \\ \hline 3 \overline{) 170} 5 \\ \underline{15} \\ 20 \end{array}$$

$$\begin{array}{r} 3 \overline{) 260} 86 \\ \underline{34} \\ 20 \\ \underline{18} \\ 2 \end{array}$$

$$\begin{array}{r} 60 \\ 45 \\ \hline 3 \overline{) 105} 35 \\ \underline{9} \\ 120 \\ \underline{15} \\ 31 \end{array}$$

$$\begin{array}{r} 3 \overline{) 154} 50 \\ \underline{150} \\ 4 \end{array}$$

PUBLIC WORKS DEPARTMENT
Camp Lejeune, North Carolina
Survey Department

File _____
Quadrangle _____
Date 2-29-55
Sheet 1 of 2

Traverse Computation
Description

Water Line and Building Location - French Creek

Station	Distance	Bearing	Cosine	Sine	Latitude	Departure	Y Coordinate North	X Coordinate East
<i>from P.C. TO P.T. curve on MAIN service Rd.</i>		<i>S 68-40-36 E</i>					<i>353,141.79</i>	<i>2,501,693.63</i>
<i>P.I. #1</i>	<i>188.06</i>	<i>N 79-12-16 W</i>	<i>1873051</i>	<i>9923018</i>	<i>35.23</i> <i>35.22 +.01</i>	<i>72</i> <i>184.73-01</i>	<i>333,177.02</i>	<i>2,501,508.91</i> X
<i>Pole R-48</i>	<i>53.6</i>	<i>S 6-37-16 E</i>	<i>9933303</i>	<i>1153032</i>	<i>53.24</i>	<i>6.18</i>	<i>333,123.78</i>	<i>2,501,515.09</i> X
<i>P.I. #2</i>	<i>1919.07</i>	<i>S 3-27-14 W</i>	<i>9981836</i>	<i>0602452</i>	<i>1914.87</i> <i>1915.58</i>	<i>60</i> <i>115.64-01</i>	<i>331,262.15</i>	<i>2,501,393.37</i> X
<i>Pole R P 8</i>	<i>127'</i>	<i>N 8-11-44 E</i>	<i>9897873</i>	<i>1425522</i>	<i>125.70</i>	<i>18.10</i>	<i>331,387.85</i>	<i>2,501,411.41</i> X
<i>P.I. #3</i>	<i>573.61</i>	<i>S 26-58-14 W</i>	<i>8912397</i>	<i>4535325</i>	<i>511.03</i> <i>511.22 - .19</i>	<i>14</i> <i>260.15-01</i>	<i>330,751.12</i>	<i>2,501,411.41</i> X
<i>P.I. "A"</i>	<i>470.64</i>	<i>S 66-11-11 E</i>	<i>4037626</i>	<i>9148638</i>	<i>190.03</i>	<i>430.57</i>	<i>330,561.09</i>	<i>2,501,561.09</i> X
<i>Cor. 1 Bldg. FC 9</i>	<i>69.40'</i>	<i>N 5-46-49 E</i>	<i>9949154</i>	<i>1007138</i>	<i>69.05</i>	<i>6.99</i>	<i>330,630.14</i>	<i>2,501,570.14</i> X
<i>Cor 2 FC 9</i>	<i>64.50'</i>	<i>S 58-13-49 W</i>	<i>5265066</i>	<i>8501710</i>	<i>33.96</i>	<i>54.84</i>	<i>330,527.13</i>	<i>2,501,508.13</i> X
<i>Cor 3 FC 8</i>	<i>27.00'</i>	<i>S 25-31-49 W</i>	<i>9023577</i>	<i>4309880</i>	<i>24.36</i>	<i>11.64</i>	<i>330,536.73</i>	<i>2,501,552.73</i> X
<i>Cor 4 FC 8</i>	<i>125.70'</i>	<i>S 46-26-11 E</i>	<i>6891595</i>	<i>7246097</i>	<i>86.63</i>	<i>91.08</i>	<i>330,545.46</i>	<i>2,501,654.46</i> X
<i>P.I. #4</i>	<i>2107.43</i>	<i>S 34-30-14 W</i>	<i>8240877</i>	<i>5664622</i>	<i>1736.08</i> <i>1736.71-63</i>	<i>70</i> <i>1193.78-08</i>	<i>329,015.04</i>	<i>2,499,931.04</i> X

